

ASSEMBLY INSTRUCTIONS

ITEM DESCRIPTION:

ITEM NO: DLC57	NAME: NOBLE MULTI DROP CHANDELIER
MATERIAL TYPE: IRON, CRYSTAL	FINISH: ANTIQUE BRASS
SOCKET TYPE: LED	SOCKET QTY: 6
BULB WATTAGE: 24W	
VOLTAGE: 100V-120V	ITEM NET WEIGHT: 51.7LBS

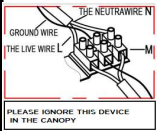
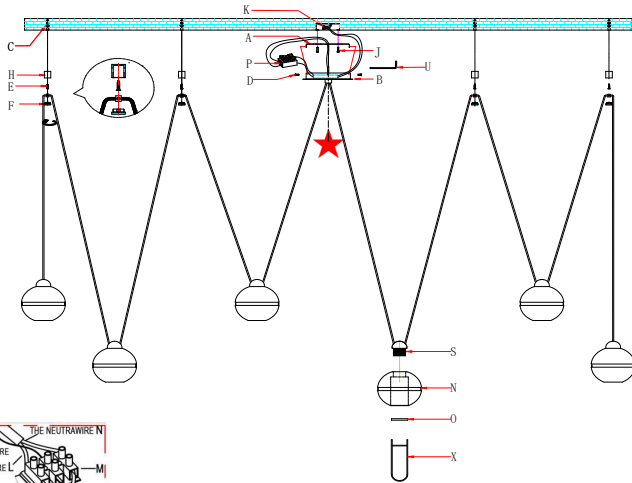

PARTS INCLUDED:

Mounting Plate (A)	Qty: 1PC	Fabric Cord (M)	Qty: 1PC
Canopy (B)	Qty: 1PC	Fast Connector (P)	Qty: 1PC
Anchor (C)	Qty: 5PCS	Dome (S)	Qty: 6PCS
Canopy Hex Screws (D)	Qty: 3PCS	Crystal shade (N)	Qty: 6PCS
Strengthen Screw (E)	Qty: 4PCS	Ring (O)	Qty: 6PCS
Metal Cover (F)	Qty: 4PCS		
Notching Metal Cap (H)	Qty: 4PCS		

HARDWARE INCLUDED:

Mounting Screw (J)	Qty: 2PCS
Plastic Wire Connector (K)	Qty: 3PCS
Green Ground Screw	Qty: 1PC
Allen Wrench (U)	Qty: 1PC
Wrench (X)	Qty: 1PC

TO INSTALL YOU WILL NEED:

- 2 people recommended
- Phillips Screwdriver
- Allen Wrench

These instructions are provided for safety. It is very important that they are read carefully and completely before beginning installation.

We strongly suggest that all hard-wired fixtures must be installed by a professional electrician.



TO ASSEMBLE:

1. Shut off the main electrical supply from the main fuse box/ circuit breaker.
2. Carefully unpack all fixture parts and hardware and lay them on a soft surface for assembly.
3. Gently pull wiring down from ceiling junction box and allow to hang.
4. Remove mounting plate(A) from the canopy(B) by unscrewing the canopy screw(D) using Allen wrench (U) .
5. PLEASE PAY SPECIAL ATTENTION TO THE FACT THAT YOU DO NOT NEED TO CONNECT THE TERMINAL BLOCK(M). IT IS USED FOR WIRE CONNECTIONS IN THE EUROPEAN MARKET.
6. Carefully inspect the chandelier's fixture wires. Neutral fixture wire: White ; Hot fixture wire: Black ; Ground wire: Bare wire
7. Wrap ground wire of lamp assembly and ground wire of junction box together and fasten together with a wire nut and wrap the connection with electrical tape.
8. Attach the neutral fixture wire from the chandelier to the neutral junction box wire (usually white). Fasten each together with a wire nut and wrap the connection with electrical tape.
9. Attach the hot fixture wire from the chandelier to the hot junction box wire (usually black). Fasten each together with a wire nut and wrap the connection with electrical tape. DO NOT REVERSE THE HOT AND NEUTRAL CONNECTIONS OR SAFETY WILL BE COMPROMISED.
10. Connect the power wires of the lamp together using the fast connector (P). Connect the black wire to the positive electrode and the white wire to the negative electrode of the fast connector (P).
11. Gently tuck the wire connections(K) neatly into the ceiling junction box.
12. Place the mounting plate(A) over the center of the ceiling junction box.
13. Align holes in mounting plate(A) with holes in junction box and attach with two mounting screws(J). Secure screws with a Phillips head screwdriver.
14. Push canopy(B) up over the mounting plate(A) until it is flush with the ceiling. Secure canopy(B) by 3 canopy screw(D) and secure screws with an Allen wrench (U) .
15. Fix the notching metal cap (H) with a strengthened screw (E) by screwing it into the anchor (C). Fix the fabric cord to the ceiling by attaching the Metal Cover (F) to the Notching Metal Cap (H) and then secure it by turning in clockwise direction till tight.
16. Attach the crystal shade (N) on the dome (S) and secure it with the ring (O) by a wrench (X).
17. Restore power to junction box and test fixture.
18. **NOTES:** To ensure the Crystal shade(O) hang straight down and the cords be equidistant, please install the fixture from center canopy first then small canopy. And the pendant is already pre-set to intend cord length as received. If you prefer a different drop, you can adjust the cord length as next page showed.
19. Precaution: This product is suitable for TRIAC dimmer switch, switch model recommended: LUTRON #DVL-153P, LUTRON #DVELV-300P

CARE INSTRUCTIONS:

Wipe with a soft, dry cloth. To protect finish, avoid the use of chemicals and household cleaners.

For customer service questions call 1-800-338-2150

ARTERIO RS

WARNING:

**INSTALL BEFORE RESTORING
POWER AT THE BREAKER**

LOW VOLTAGE LED DRIVER INSIDE.

**DO NOT APPLY POWER AT THE BREAKER
OR SWITCH UNTIL FIXTURE IS FULLY INSTALLED.
FAILURE TO FOLLOW INSTRUCTIONS MAY RESULT
IN MALFUNCTION AND WILL VOID WARRANTY.**

ADJUSTABLE CORD LENGTH – ASSEMBLY INSTRUCTIONS

PRECAUTIONS:

To ensure the Crystal shade hang straight down and the cords be equidistant, please install the fixture from center canopy first then small canopy as below showed.

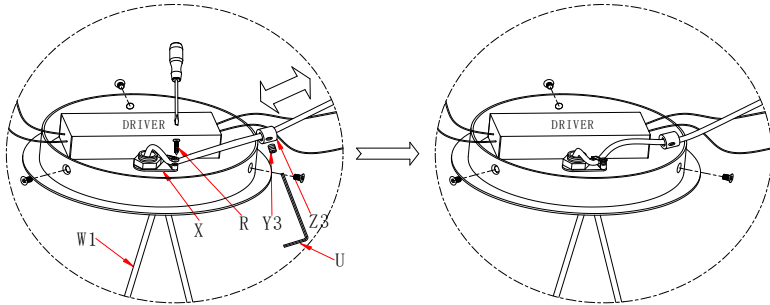
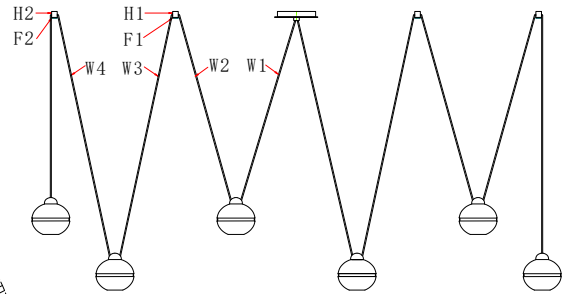

1. Use a flat-head screwdriver to loosen the screw (R) on the wire anchor (X) and the plastic screw (Y3) on the wire grip (Z3). Adjust the fabric cord (W1) to the desired length and then tighten the plastic screw (Y3).

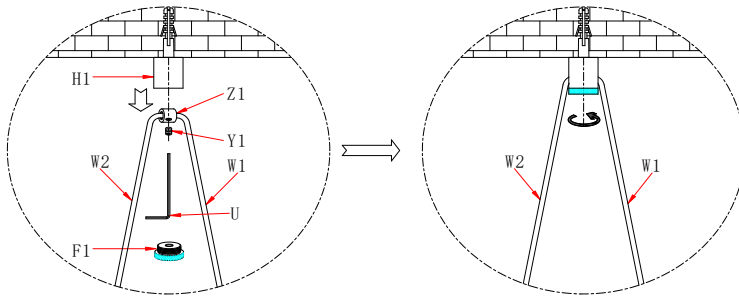

2. Unscrew the knurling metal cover (F1). Loosen the small screw (Y1) on the wire grip (Z1) with an Allen wrench, adjust the length of the cord (W2) to be the same as that of the power cord (W1), then tighten the plastic screw (Y1).

3. Insert the cord with the wire grip (Z1) into the notching metal cap (H1), then secure with the knurling metal cover (F1) till tight.

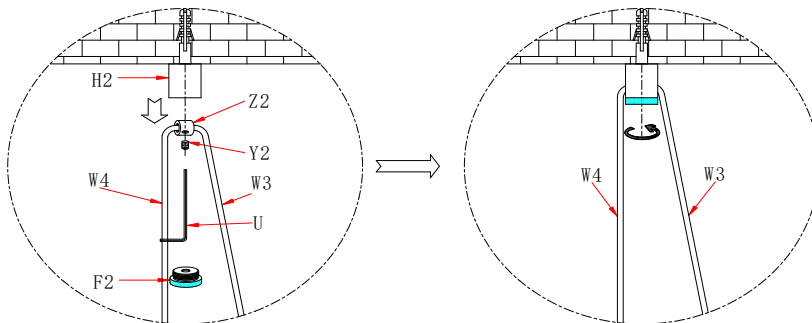

4. Unscrew the knurling metal cover (F2). Loosen the small screw (Y2) on wire grip (Z2) with an Allen wrench, adjust the length of the cord (W4) to be the same as that of the power cord (W3), then tighten the plastic screw (Y2).

5. Insert the cord with the wire grip (Z2) into the notching metal cap (H2), then secure with the knurling metal cover (F1) till tight. the knurled round cover (F2).

6. The left side is completed. Then can repeat the same operation in sequence for the right right.