

ARTERIOS

MOWGLI MIRROR

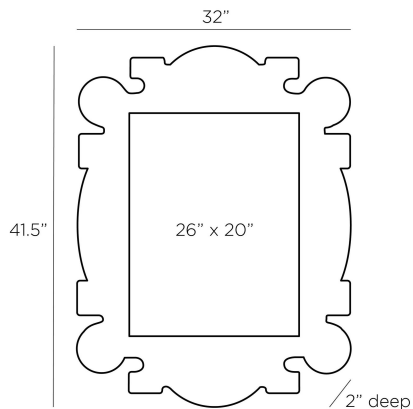

5733
Tobacco Stained, Abaca

Rich textures and lines come together to form the unique sophistication of this wall mirror. The ornate frame shape is inspired by maximalist style, while its natural hues and modern aesthetic allow this mirror to work in any space. The frame is wrapped in tobacco-stained abaca, known for its durable fibers. Security cleat hanging hardware to hang both vertically and horizontally. Finish will vary.

APPEARANCE

Materials	Abaca, Abaca, Mirror
Finishes	Tobacco Stained, Tobacco Stained, Plain
Finish Will Vary	Yes
Top Coat/Sealant	No

DIMENSIONS

Overall	W: 32 in x D: 2 in x H: 41.5 in
Actual Mirror	W: 20 in x H: 26 in

SHIPPING

Shipping Requirements	Truck Ship
Product Weight	33.84 lbs
Gross Weight 1	47.7 lbs
Shipping Box 1	W: 4.75 in x D: 35.75 in x H: 45.75 in

ADDITIONAL INFO

Hanger Position	Vertical & Horizontal
-----------------	-----------------------

CONTRACT

Contract Suitability	Contract Suitable As Is
----------------------	-------------------------