

ARTERIOS

LENNON FLUSH MOUNT

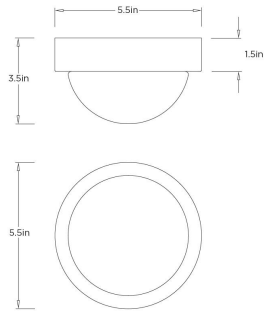

DFC22 LENNON FLUSH MOUNT

ARTERIOS



DFC22
English Bronze, Steel

Lennon's rounded fixture of chattered steel finished in English bronze holds an orb of seeded slump glass, creating a tactile interplay of texture and shine. This frosted LED flush mount casts a soft, ambient glow, and multiple fixtures can be grouped for dramatic effect as a wall sconce. Certified for damp locations and intended for interior use. Finish will vary.

APPEARANCE

| | |
|------------------|-------------------------|
| Materials | Steel, Slump Glass |
| Finishes | English Bronze, Frosted |
| Finish Will Vary | Yes |
| Top Coat/Sealant | Yes |

DIMENSIONS

| | |
|---------|-------------------------|
| Overall | Dia: 5.5 in x H: 3.5 in |
|---------|-------------------------|

WIRING

| | |
|-----------------------|--------------------------|
| Wire Rating | Damp |
| Cord | 0.5 FT, Black/White, SVT |
| Socket | 1, Integrated LED |
| Maximum Wattage | 7.0 |
| Voltage | 110-120 V |
| LED Color Temperature | 2700K |
| LED Compatible Dimmer | Non-Dimmable |
| LED CRI | 90+ |
| LED Lifespan (Hours) | 30,000 |
| Spare Driver Included | No |

CERTIFICATIONS & COMPLIANCY

| | |
|----------------|-------------------------------|
| Certifications | Mexico, United States, Canada |
| Compliance | RoHS, UL/ETL |

SHIPPING

| | |
|----------------|-----------------------------------|
| Product Weight | 1.7 lbs |
| Gross Weight 1 | 6.7 lbs |
| Shipping Box 1 | W: 1.7 in x D: 7.5 in x H: 8.5 in |

CONTRACT

| | |
|----------------------|-------------------------|
| Contract Suitability | Contract Suitable As Is |
|----------------------|-------------------------|

REPLACEMENT PARTS

DS12W12