

ARTERIOS

CHAMPLAIN COFFEE TABLE

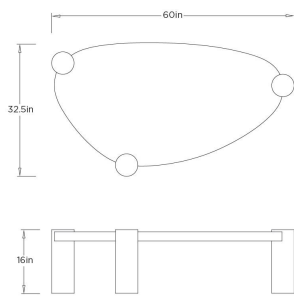

FCM02 CHAMPLAIN COFFEE TABLE

ARTERIOS



FCM02
Stone Veil, Lacquer

The Champlain Coffee Table embodies organic fluidity in a soft, creamy lacquer that lends a warm, sculptural presence. The freeform top, shaped with a natural, flowing asymmetry, introduces a softened silhouette, while three cylindrical column legs provide a bold, architectural counterpoint. Each leg is accented with a gentle concave detail at the crown, lending subtle sculptural dimension to the high-gloss surface.

APPEARANCE

Materials	Lacquer, Lacquer
Finishes	Stone Veil, Stone Veil
Finish Will Vary	No
Top Coat/Sealant	No

DIMENSIONS

Overall	W: 60 in x D: 32 in x H: 15.5 in
Foot Print	W: 60 in x D: 32 in
Leg	Dia: 5.5 in x H: 13 in
Clearance	H: 13 in
Table Top	W: 56 in x D: 30 in
Table Top Thickness	H: 2 in

SHIPPING

Shipping Requirements	Special Handling Required
Product Weight	48.2 lbs
Gross Weight 1	58 lbs
Shipping Box 1	W: 37 in x D: 63 in x H: 19 in

ADDITIONAL INFO

Base/Foot Type	Adjustable Glides
----------------	-------------------

CONTRACT

Contract Suitability	Contract Suitable With Conditions
Contract Conditions	For an additional fee, a clear, protective coating can be added

SWATCHES

SVLSW 4x4 Swatch: Stone Veil Lacquer