

MIRIAM LAMP



PTC68-441
 Ivory Crackle, Ceramic
 H: 30.5 IN
 Dia: 20.0 IN



Drawing inspiration from the sinuous lines of Art Nouveau, this hand-crafted ceramic lamp features an elegant, flowing silhouette perched on four spherical feet that echo the base's detailing. Glazed in an ivory crackle finish that contrasts with polished nickel-plated steel hardware, it is topped with an ivory microfiber drum shade lined in off-white cotton. Finish will vary

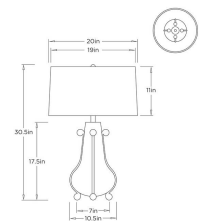

PTC68-441 MIRIAM LAMP

ARTERIOS